

Incold PE skirting boards are designed to meet the requirements of shopfitting and cold storage facilities.

They are a machined extruded solution, designed to ensure protection and hygiene in environments that demand high standards of chemical and mechanical resistance. Thanks to the thermoplastic nature of the material (PE300), they offer a flawless finish and superior durability compared to traditional materials.

The bumpers are made from high-quality plastic (PE300) with the following characteristics:

CHARACTERISTICS	TEST METHOD	PARAMETERS	UNITS	VALUE
<b>Density</b>	ISO 1183		g/cm <sup>3</sup>	0,95
<b>Melt index</b>	ISO 1183	190°C / 21,6 kg	g/10 min	11
<b>Tensile strength</b>	DIN EN ISO 527	50 mm/min	MPa	23
<b>Elongation at break</b>	DIN EN ISO 527	50 mm/min	%	9
<b>Modulus of elasticity</b>	DIN EN ISO 527	1 mm/min	MPa	800
<b>Impact strength</b>	ISO 179	+23 °C	KJ/m <sup>2</sup>	20
<b>Shore D hardness</b>	ISO 868	15 sec.		64
<b>Ball hardness</b>	ISO 2039-1		MPa	41
<b>Volume resistivity</b>	IEC 60093	1 MIN – 1000V	Ω *cm	>10 <sup>15</sup>
<b>Surface resistivity</b>	IEC 60093		Ω	>10 <sup>15</sup>
<b>Dielectric strength</b>	IEC 60243-1		kV/mm	48
<b>Dielectric constant</b>	IEC 60250	50 kHz		2,35
<b>Dielectric loss factor</b>	IEC 60250	106 Hz	tan δ	3,5 × 10 <sup>-4</sup>
<b>Average coefficient of linear expansion</b>	DIN 53752		10 <sup>-4</sup> x K <sup>-1</sup>	1,5 – 2,0
<b>Fire behaviour</b>	DIN 4102			B2 (o.P.)
<b>Operating temperature range</b>				-50°C / +80°C

The skirting boards supplied have the following specifications:

- Length: 3000 mm
- Dimensions: 200×15 mm (code 02030157)
- Colour: White RAL 9010
- Shape: 10×45° chamfers
- Holes: 10 holes along the centreline, Ø 6.5 mm with a Ø 14.5 mm countersink for sealing with a plug (04730000)

#### Assembly and installation instructions

- They can be cut to size on site using standard woodworking machinery.
- For corner finishes, 1500 mm long components with a 45-degree bevel are provided.  
External corners: 1× 02030158 + 1 × 02030159  
Internal corners: 1× 02030160 + 1 × 02030161
- Silicone must be applied evenly between the wall and the impact guard.  
The food-grade silicone supplied by INCOLD is:
  - **04015052 ISEGA-certified white sealant**
  - **Quantity:** 1 × 290 ml cartridge per 8 m.
- **Rivets** are required for wall fixing.  
The choice of rivets depends on the thickness of the impact guard and the type of surface of the panels to which the impact guards are fixed. We recommend referring to the following table:

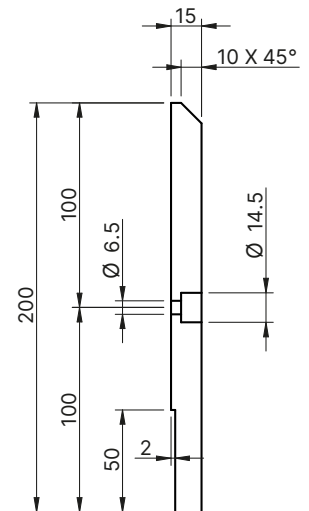

SHEET METAL SURFACE	FIBREGLASS SURFACE (GLASINCOLD)
Rivets Ø6 × 30 with aluminium body – steel shank	“FIORIV” flower-head rivets, Ø5 × 30 Aluminium body – Steel nail
<b>Code:</b> 04920032	<b>Code:</b> 04920034
<b>Quantity:</b> 10 per 3 m of skirt board	<b>Quantity:</b> 10 per 3 m of skirt board